

18.4  
SWING RADIUS

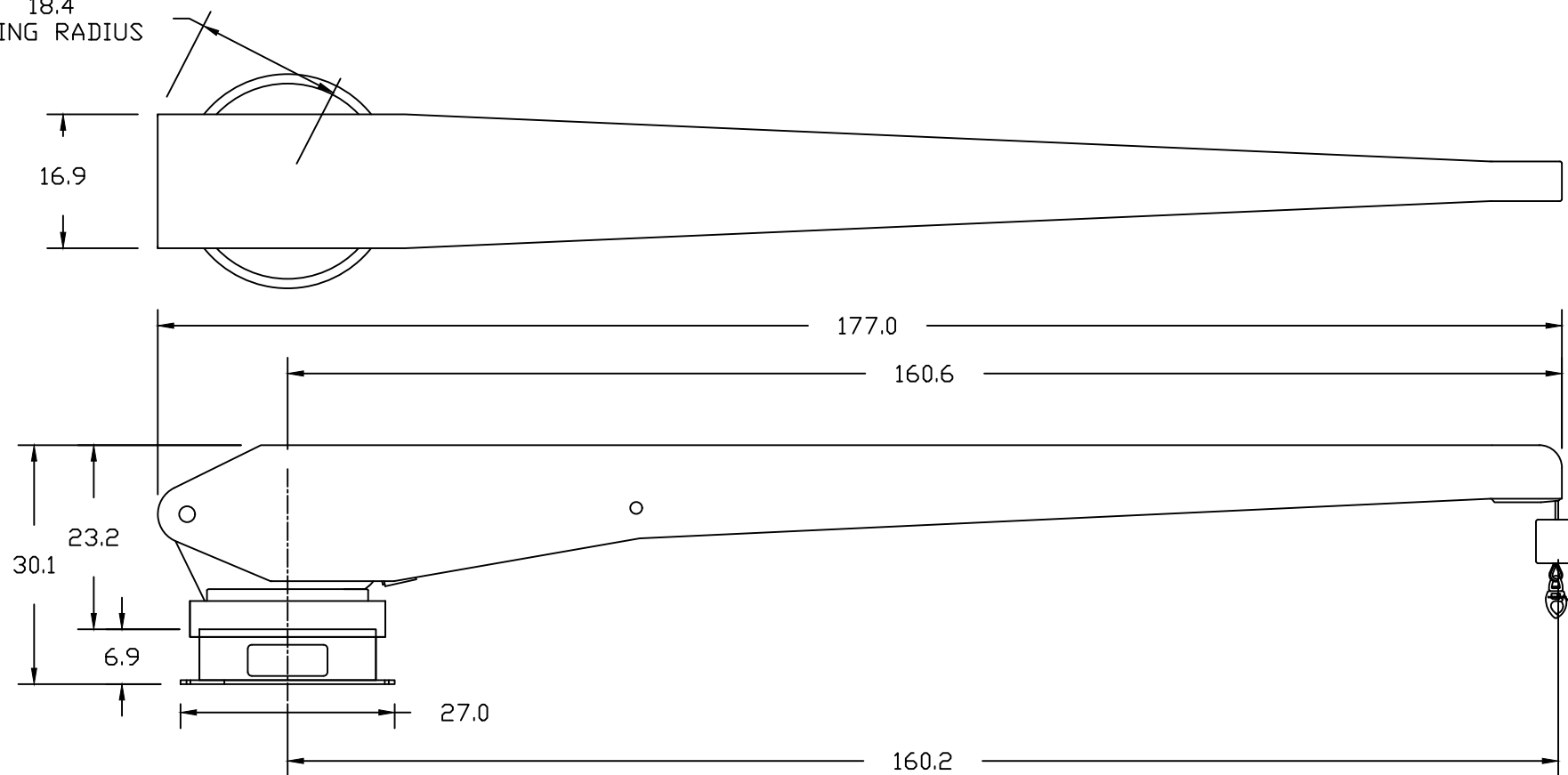

RATED FOR 2500LBS  
STANDARD BOOM LENGTHS FROM 136-180  
STD CABLE TRAVEL=26 FT  
MAX BOOM ELEVATION ANGLE=67°  
MIN REACH FOR 160 BOOM SHOWN=51" @ 67°  
NORMAL ROTATION=348.5 DEGREES

COPYRIGHT 1995

**MarQuipt**

This drawing is to be used  
solely for work authorized in writing.  
All rights of design are reserved.  
Reproduction or unauthorized use  
of this drawing is forbidden and will  
be considered an infringement of  
these rights. Drawing is to be  
returned upon completion of  
authorized work.

**MarQuipt**

3100 S.W. 10TH ST. POMPANO BEACH, FL 33069  
TL (954) 957-8333 / FAX (954) 957-8330

DRAWING: TENDER LIFT 2500

PROJECT: SALES STD	PAGE: 1 OF 1
DATE: 10/19/18	DRAWN BY: TIM S
PATH: ///TL2500 GB PINION	